

EUROCAVE

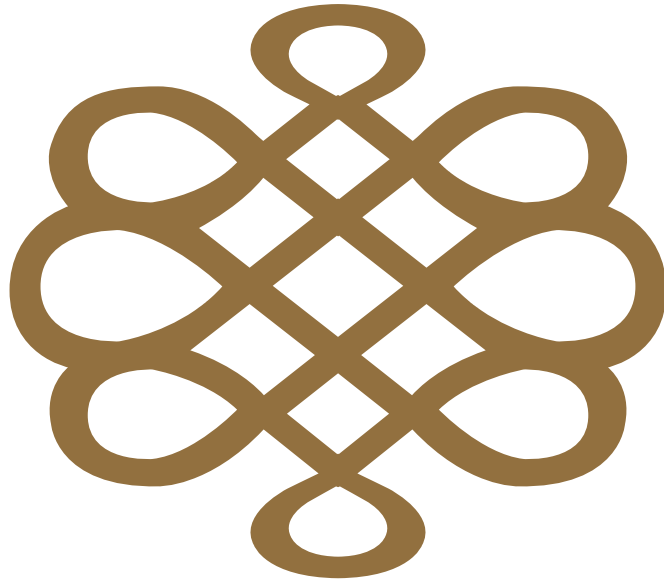

BVCert. 6010761



EUROCAVE

Inventor of the wine cabinet

For over 40 years, EuroCave has become the gold standard worldwide for maturing and serving wine.

The challenge laid down by the company's founders was to create a specific product that respects and enhances wine, in order to enable connoisseurs to fully live out their passion.

In a changing environment, the brand's identity and values have been affirmed and refined:

- precision at the service of time management.
- knowledge of wine cultivation, businesses, languages.
- the pleasure and poetry of wine-tasting.
- a will to promote wine-making culture.

Today, bolstered by a powerful network, a team of passionate advisors and a high-performance production plant, the brand can be found all over the world.

Established in 1976, EuroCave has become a brand at a timeless crossroads between tradition and modernity.

The 6 advantages offered by EuroCave

For optimal maturing of your wine,
EuroCave respects the requirements of your finest wines.

1 A constant temperature

The EuroCave thermal control system

This Twin Process system is made up of a dual hot/cold circuit. It recreates the specific climate of the best natural cellars. Thanks to high precision sensors, Twin Process carries out real time corrections to fluctuations in temperature. In this way, a constant temperature of 10 - 14°C, is ensured inside the cabinet whatever the external environment (0 - 35°C). A uniform temperature is ensured by the walls, made of aluminium, well known for its excellent thermal conductivity.

2 A suitable level of humidity

A uniform, controlled level of humidity

EuroCave's Hygro+ systems ensure that your wine maturing cabinet has a level of humidity above 50%, to prevent your corks from drying out and, as a result, irreversible oxidation of your wine. Furthermore, EuroCave cabinets are the only cabinets to be fitted with an automatic display and a humidity alarm system.

3 Effective thermal insulation

A cellular insulant to protect your wine from the elements

CQI - insulant, combined with thick walls (5cm) form a double thermal barrier, which ensures optimal protection against temperature variations. Insulation is essential as it prevents temperature fluctuations and reduces power consumption. EuroCave's insulation provides protection equivalent to almost 2 metres of earth, as is the case in a natural cellar.

4 A permanent ventilation system

The breather effect

EuroCave wine cabinets benefit from a ventilation system with breather effect, very similar to the ventilation system of a natural cellar. The air circulates via 2 openings located at the top and bottom of the cabinet. The air enters through the top opening, fitted with a charcoal filter which purifies the air and prevents bad odours. Furthermore, the constant renewal of air prevents mould from forming in your cabinet.

5 An anti-vibration system

Protection against premature wine ageing

Vibrations disturb wine's maturing process. The VES (Vibration Exclusion System) provides your cabinet with a barrier against vibrations with several levels of protection. The cabinet compressor is separate from the body, which prevents vibrations being transmitted to it. Furthermore, the shelves are fitted with several shock absorbers and the cabinet feet ensure complete stability.

6 Storage capacity

Storage specifically designed for wine bottles

Contrary to other cabinets in the electrical goods market, EuroCave cabinets are specifically designed to store wine bottles. The bottles are stacked at double depth (top and tailed) and are perfectly supported in the specially designed recesses. A steel frame and stiffener strengthen the structure of the cabinet to allow it to support the weight of the bottles and prevent the body from buckling.



Première

Simple yet expert

"Première" as in first occasion, first use, first choice. This range allows you to take your first step to discover what the brand has to offer.

Cabinets in the Première range will impress with their bold, stylish lines. Upon closer inspection, you will notice that the handle is discreetly concealed in the side of the door. When you open the door, your eyes will be drawn to the sophisticated control panel with its glossy, opaque design. Finally, you will find a unique feature of the cabinet - the reading light, a detachable lamp built into the cabinet, designed to illuminate your bottles and show them in their best light.

In addition to these aesthetic innovations, the range features the technical performance inherent to all of the brand's ranges, the reliability of the protection alarms as well as a reinforced lock, another feature to ensure your peace of mind.

When you gently close the door, walk away safe in the knowledge that your wines are completely protected.

Low energy consumption and noise levels

Cabinets in the Première range consume up to 60% less energy than a traditional cabinet. They are rated A to A+ depending on the type of door. And for increased user comfort, their noise level does not exceed 37dB(A).



Energy and technical features

Ref.	Dimensions H x W x D (mm)	Bottle capacity Traditional Bordeaux	Energy efficiency class	Annual energy Consumption (kwh/year)	Useful volume (liters)	Sound Emission (dB(A))	Permitted temperature range (°C)
V-PREM-S	960 x 680 x 690	74 - 92	A / A+	114	225	37	0 - 35
V-PREM-M	1480 x 680 x 690	141 - 169	A / A+	121	355	37	0 - 35
V-PREM-L	1825 x 680 x 690	182 - 213	A / A+	128	460	37	0 - 35

S

V-PREM-S

Size(mm): 960h x 680w x 690d
Capacity: 74 - 92 bottles (Traditional Bordeaux)



M

V-PREM-M

Size(mm): 1480h x 680w x 690d
Capacity: 141 - 169 bottles (Traditional Bordeaux)



L

V-PREM-L

Size(mm): 1825h x 680w x 690d
Capacity: 182 - 213 bottles (Traditional Bordeaux)





Pure

With Pure, store your wine... naturally

The evocative and symbolic name given to all of the cabinets in this range whether they are maturing, multifunctional or serving cabinets. Cabinets that have been meticulously thought-out and designed to house your wines, save energy and thus protect our precious environment. The Pure range represents a new generation of wine cabinet. A wind of change that signifies a return to our roots, a clever balance of cutting-edge technology and respect for nature. These elegantly understated cabinets will provide shelter for your wines and cherish them in a muffled cocoon until they have reached their true potential, far from variations in temperature and hygrometry, harmful U.V. rays and vibrations... as if protected within a cozy cocoon, where the poetry of wine becomes an ode to the future.

Low energy consumption and noise levels

Cabinets in the Pure range consume up to 60% less energy than a traditional cabinet. They are rated A to A+ depending on the type of door. And for increased user comfort, their noise level does not exceed 37dB(A).



Energy and technical features

Ref.	Dimensions	Bottle capacity	Energy efficiency class	Annual energy Consumption (kwh/year)	Useful volume (liters)	Sound Emission (dB(A))	Permitted temperature range (°C)
	H x W x D (mm)	Traditional Bordeaux					
V-PURE-S	960 x 680 x 690	74 - 92	A / A+	114	210	37	0 - 35
V-PURE-M	1480 x 680 x 690	141 - 169	A / A+	121	340	37	0 - 35
V-PURE-L	1825 x 680 x 690	182 - 213	A / A+	128	445	37	0 - 35
E-PURE-L	1825 x 680 x 690	165 - 190	A / A+	128	450	37	12 - 30
S-PURE-S	960 x 680 x 690	74	A / A+	114	225	37	12 - 30
S-PURE-M	1480 x 680 x 690	141	A / A+	121	355	37	12 - 30
S-PURE-L	1825 x 680 x 690	182	A / A+	128	460	37	12 - 30

V-PURE-S

Size(mm): 960h x 680w x 690d
Capacity: 74 - 92 bottles (Traditional Bordeaux)



V-PURE-M

Size(mm): 1480h x 680w x 690d
Capacity: 141 - 169 bottles (Traditional Bordeaux)



V-PURE-L

Size(mm): 1825h x 680w x 690d
Capacity: 182 - 213 bottles (Traditional Bordeaux)





Revelation

A range of cellar "cozy" all options

"The finesse of one's movement reveals that of his feelings." - African proverb The Revelation range provides wine lovers with virtually custom solutions! It offers EuroCave's latest patented innovations in terms of wine cabinet features:

And then there was light...

Sparkling presentation for your bottles - this is what the Revelation range offers. A strip of light all around the cabinet bathes your bottles in a halo of amber which dramatically highlights the inside of the cabinet... UV-free lighting to safely accentuate your bottles.

Smooth handling

By creating this new range, we wanted to offer a new generation interior layout, for improved ergonomics and ease of use. Discover how to best arrange, store and organise your wines.

Identify your wines



New epoxy-coated steel labels on which you can write information about your precious bottles. Up to 6 detachable labels per shelf. White felt-tip pen supplied (erasable).

new generation Main du Sommelier



This structure in two materials cradles your bottles and protects them from vibration. It is detachable, allowing it to adapt to your storage requirements in terms of bottle shape and number. The Main du Sommelier allows easy placement of your bottles. User-friendly, your bottles will slip easily into place.

Sliding shelf

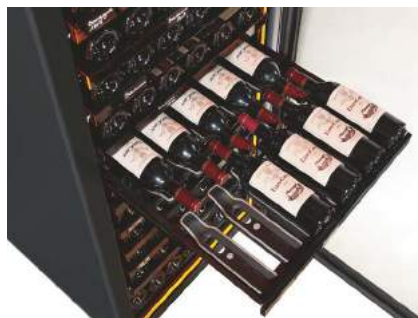

Capacity for up to 12 bottles

Designed for improved aesthetics and fluidity of use, the new structure of the sliding shelf conceals all of its technical features beneath its stylish curves. It has a soft-close device which slows the speed of the shelf at the end of travel. Holding your bottles safely and securely.



Model: V-REVEL-L
Size(mm): 1825h x 680w x 690d
Capacity: Approx. 182 bottles



Compact

Flush-fitting and save-spacing guaranteed

The free standing version of Compact range cabinets is ideal for space saving, owing to its specific dimensions. The flush-fitted version is ideal for the kitchen.

- Dimensions adapted to the requirements of kitchen designers.
- Available for maturing cabinets (1-temperature) or wine serving cabinets (multi-temperature).
- You do not have to cut extra ventilation holes in your work surface for the small model. There is a front venting system at the base of the cabinet, which must not be covered.
- Possibility to fit the cabinet with a technical door.



Energy and technical features

Ref.	Dimensions	Bottle capacity	Annual energy Consumption	Useful volume	Sound Emission	Permitted temperature range
S - multi-temperature						
V - 1 temperature	H x W x D (mm)	Traditional Bordeaux	(kwh/year)	(liters)	(dB(A))	(°C)
V-059V2	822 x 595 x 566	38 - 47	383	111	42	0 - 35
S-059V2	822 x 595 x 566	38	347	119	42	12 - 30
V-259V2	1782 x 595 x 580	118 - 164	456	318	42	0 - 35
S-259V2	1782 x 595 x 580	118	402	325	42	12 - 30



Cigar

A Cigar, a timeless moment...

Enjoying a cigar, is not only to savour all of its flavour but also to enjoy a special relationship with time.

The time taken to appreciate, to inhale, to gently roll between the fingers, to prepare before smoking, these are special moments for all lovers of fine cigars. Unforgettable shared moments. Whilst smoking a cigar, let time do what it will...

Thanks to an exclusive temperature and hygrometry regulation system, EuroCave guarantees optimum preservation of your cigars:

- A constant temperature between 9°C (48°F) and 18°C (64°F).
- Hygrometry between 65% and 75%.

To simplify service, these cabinets are equipped with a wooden presentation tray and a sliding drawer.



Model: CC 064V3
 Colour: Buffle
 Size(mm): 950h x 655w x 690d
 Capacity: Approx. 40 boxes

THE PLEASURE OF PRESENTING YOUR CIGARS

The Cigar Humidor has been designed to be evolutionary. Several kinds of layouts are on offer, in order to best meet your requirements.



Presentation tray on sliding rack (in rot-proof exotic wood).



Storage drawer



Tête à tête

The first wine bar in a wine serving cabinet

A real gem of a cabinet, Tête à tête is attractive, innovative and ingenious.

- Allows you to bring 12 bottles of wine (white or red) to the correct serving temperature for wine ready to be served whatever the circumstances.
- Set with 2 detachable oxygen extraction heads, la Petite allows you to store 2 opened bottles for up to 10 days, by protecting them from oxidation.
- The temperature is easy to set thanks to the tactile control panel on the front, with backlit keys.
- Available in black, with a glass door and elegant glass top. Discover its many facets.



Technology and expertise

Tête à tête benefits from all of EuroCave's expertise:

- A choice in the temperature of the bottom and top of the cabinet*.
- A touch panel with backlit keys outside of the cabinet.
- 10 Main Du Sommelier anti-vibration ergonomic bottles supports.
- The compressor enables a temperature difference of 10°C between the bottom and top of the cabinet.
- 2 oxygen extraction heads with constant vacuum monitoring.
- Permanent lighting for your bottles.
- An elegant glass cover.
- Attractive finish at the back.
- Available in black with a full glass straight door only.

	Temperature zones	Temperature setting range	Oxygen extraction	Length of time opened bottles can be stored	Dimensions (mm)	Weight (kg)	Temperature range	Consumption per 24h (KWh)**
S013	Multi-temperature	6°C to 22°C*	Vacuum pressure 300 Mbars min.	Up to 10 days	H850xW297 xD462	25	MinT° : 18°C MaxT° : 30°C	0.44

* The compressor enables a temperature difference of 10°C. Adjust the setting to 6°C and the top of your cabinet will automatically adjust to 16°C. In the same manner, if you adjust the bottom of the cabinet to 12°C, the top will display a temperature of 22°C.

** Consumption per 24 hrs measured with an external temperature of 20 °C.



Wine Art

The home wine bar

Wine Art... guarantee that your wine will be at a perfect serving temperature thanks to the service temperature system... allows all of the flavours of your wine to remain intact, allows you the freedom to drink a bottle opened several days ago at your own pace, thanks to the air vacuum system.



Two bottles at and ideal serving temperature

In order for wine to fully develop and release all of its flavours, it must be served at the correct temperature. Therefore, red wine needs to be served at about 16°C and white or rosé wine at about 8°C.

The exclusive Wine Art system has two separate compartments, allowing you to bring 2 bottles of red and/or white to the correct serving temperature.

Flavour retained several days after opening your wine

Once opened, your bottles can be put back in a Wine Art compartment. The innovative air extraction system ensures that your wine is protected from risk of oxidation up to a maximum of 10days after it has been opened.

made in China



Technical specifications

Reference	Dimensions (mm)	Weight	Power Supply	Capacity
WINE ART	478h x 245w x 248d	5.48 kg	230VAC 50Hz	70W

Operating Ambient Temperature Range: 18 - 25°C

The Modulothèque

A unique storage system

With the Modulothèque, EuroCave offers an exclusive modular storage system in solid oak. You can build up a totally personalised unit, that will evolve as and when you need it to.

What is a Modulothèque?

Your wine deserves to be stored in the very best conditions... That's why the EuroCave Modulothèque guarantees an optimal storage quality.



Furniture tailored to your needs



A Robust Structure

The EuroCave Modulothèque is crested in solid oak. The thickness of the solid oak used (20mm) offers a high level of robustness and total stability to the Modulothèque, irrespective of the final dimensions. Oak is naturally resistant to humidity and fungous growth. The "transparent linseed" oiled finish nourishes the wood and alone ensure the Modulothèque's maintenance for several years.



Base and Stability Solutions

The EuroCave Modulothèque rests on feet made of aluminium, a solid, age and stress resistant material. They can be adjusted in height to ensure the total stability of the units and to compensate for uneven floors. The basic Modulothèque modules are equipped with shelf supports, also in aluminium, enabling the bottle shelves to be located in total security.



Storage Features

Just like the EuroCave wine cabinets, the Modulothèque has multiple storage units adapted to wine preservation, thanks to several bottle shelf modules. The wide selection of wine presentation modules enables you to store your bottles as you wish, and to create a totally personalised item of furniture.

*With the exception of the presentation kit, all of the Modulothèque bottle shelves have an oak facing.

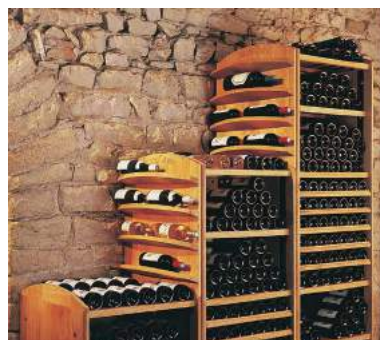



Modolorack

An exclusive system for storing your cases

The EuroCave Modolorack is an unique system for storing your wines directly in their original cases. Thanks to its exclusive sliding bottle tray system, all of your cases are immediatly and easily accessible.

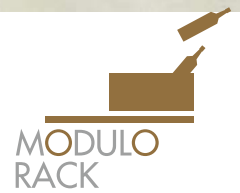

What is a Modolorack?

Designed to hold two cases of 12 bottles, the Modolorack is floor secured. Several Modoloracks can be joined together to increase your storage capacity, while still ensuring total stability when handling bottles.

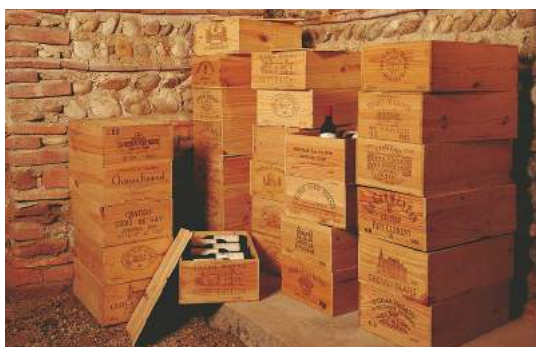

Your cases of wine are difficult to handle and your "crus" are impossible to reach?



With the Modolorack modular system, each bottle become rapidly accessible.



Sliding trays

Based on the same principle as the sliding bottle shelves in the wine cabinets, the Modolorack has an exclusive sliding tray system for storing cases of wine.

- Unit weight: 8.2kgs
- Assembled size(mm): 500h x 397w x 500d (delivered without cases)



Modulosteel

The contemporary storage system that can be personalised in an infinite number of ways!

EuroCave is adding to its range of storage systems with Modulosteel: easy to assemble modules which can be attached to each other in an infinite number of ways. A new product with clean, modern lines for a decidedly contemporary feel.

A modular design

Customisable, Modulosteel can be assembled in an infinite number of ways with its modules, which attach to each other. Can be adjusted to half its height for vaulted cellars or low ceilings!

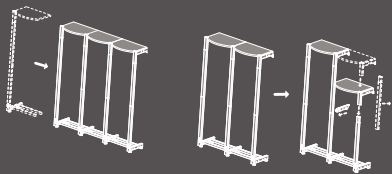

- › One bottle deep storage
- › Material: Black painted steel
- › Treated with epoxy resin to protect against damp
- › 17 storage levels, each holding up to 8 bottles

Technical features

Dim. of one storage unit	H2000 x W720 x D505 mm
Dim. of one storage half unit	H1160 x W720 x D505 mm
Centre spacing width	600 mm
Body external dimensions	H664 x W595 x D584 mm
Top cover external dimensions	H25 x W658 x D412 mm
Weight of one metal post	12.5 kg
Weight of one central bottle storage section	13.5 kg
Weight of body +shelves	46.5 kg
Weight of top cover	4.5 kg

A strong structure

The structure was designed to be easy to assemble. Three fastening systems ensure complete stability.

- › 4 adjustable cylinder bases
- › 1 screw system at the top of each metal post. To be fixed directly to the wall, using an alignment washer
- › 1 slide system at the top of each metal post in order to set and adjust any possible gap between the wall and the storage unit



Optimised storage

2 types of storage: "storage" and/or "display" mode. Simply move the steel tubes and fix the Main du Sommelier supports in the desired position.



Two optional extras available

A choice of finishes to optimise your storage area and give it a more homely feel.

Optional extra no.1

- › One body + 6 ACMS shelves
- › Increase your storage capacity: 72 bottles
- › Material: panels of black damp-proof melamine-faced MDF



Optional extra no.2

- › Finishing top cover
- › Easy to fit, on top of the central bottle storage section. Can be used on the structure at full or half-height.
- › Material: panels of black damp-proof melamine-faced MDF



The New EuroCave App

Manage your wine cabinet with ease!

*100% free - 100% practical - 100% secure
100% open to all wine cabinet owners*



- *List all of your bottles*
- *Create wine information sheets*
- *Organise your cabinet*
- *Keep a record of all the wines you have drunk*
- *Be alerted when your bottles have reached their peak*
- *Share your favourite wines with your friends*
- *Benefit from professional advice about your wine collection*
- *Print your cellar board*



*Now available
for Apple & Android*



*Direct access to the App
by scanning this QR code
with your mobile or tablet*

EUROCAVE